

NOT FOR
CONSTRUCTION

City of Avon Lake

150 Avon Belden Road, Avon Lake, OH
44012

ALPS - Avon Lake
Play Space

Bleser Park, Avon Lake, OH

Park Concept Plan

Revisions:

0 02.10.2023 Presentation

Project Number: 5140 03 22
Design by: KAT
Drawn by: KAT
Checked by: JRC

A1.0

- ① Outdoor gym ~1800 SF
- ② Infant + toddler play area ~4500 SF
- ③ Sensory & music garden ~3000 SF
- ④ Ninja Warrior course ~4000SF
- ⑤ Big kids play area ~5800 SF
- ⑥ Swings ~4200 SF
- ⑦ Zipline ~4400 SF
- ⑧ Mound ~10000 SF

- All Ages
- Infants & Toddlers
- 5 - 12 Years
- 13+ Years, Adults
- Lawn
- Seating Area

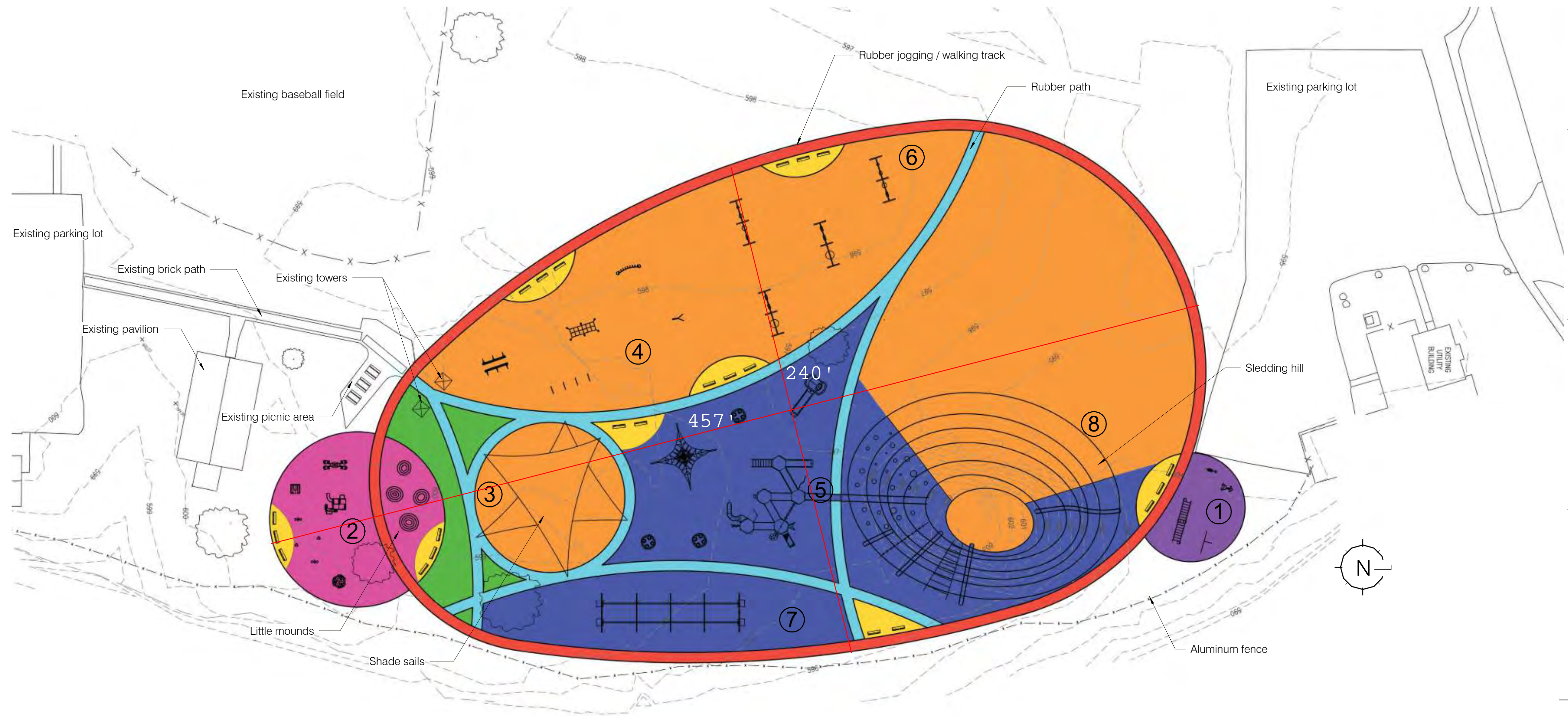

① Outdoor gym

- for ages 13+
- fixed frames (calisthenics)
- kinetic elements
- poured-in-place rubber surface

② Infant + toddler play area

- for ages 0-5
- small mounds playground w/tunnels and slides
- artificial turf + poured-in-place rubber surface
- small climbing element with slide
- small spinners
- hiding spot with peeking holes
- toddler sized picnic table
- good visibility

③ Sensory & music garden

- for all ages
- play equipment for all senses
- sensory panels
- sensory table
- talking tubes
- musical equipment (percussion, xylophon, etc.)
- poured-in-place rubber surface
- everything fully accessible from ground level
- shading elements

④ Ninja Warrior course

- for ages 5-12
- elements for climbing, jumping, hanging
- poured-in-place rubber surface

⑤ Big kids play area

- for ages 5-12
- large climbing element with slides
- ramps leading up to highest point for accessibility
- extreme rope climbing structure
- accessible swing
- accessible spinners
- accessible see-saws
- poured-in-place rubber surface

⑥ Swings

- for all ages
- variety of swing seats mixed together
- bucket seat, nest swing, molded bucket seat w/ harness, generation swing, belt seat, etc.
- swingsets facing each other and the lake
- poured-in-place rubber surface

⑦ Zipline

- for ages 5-12
- surface in middle doesn't have to be ADA accessible
- 2 or 3 bays
- disk seat, molded bucket seat w/ harness
- two-way zipline

⑧ Mound

- for all ages
- sledding hill on West side - natural lawn
- climbing hill with slides on East side w/ poured-in-place rubber surface
- top of hill accessible through bridge
- can be used all year round
- West slope modified to better work for sledding

Site features

- ADA accessible picnic tables
- park benches with armrest and full back for better accessibility
- outdoor trash cans
- aluminum fence along creek
- rubber running/jogging track around play area
- pole site lighting (~12 poles)

